

XYG440-A 2軸/2-axis

▶ 螺桿驅動
Ball Screw Drive

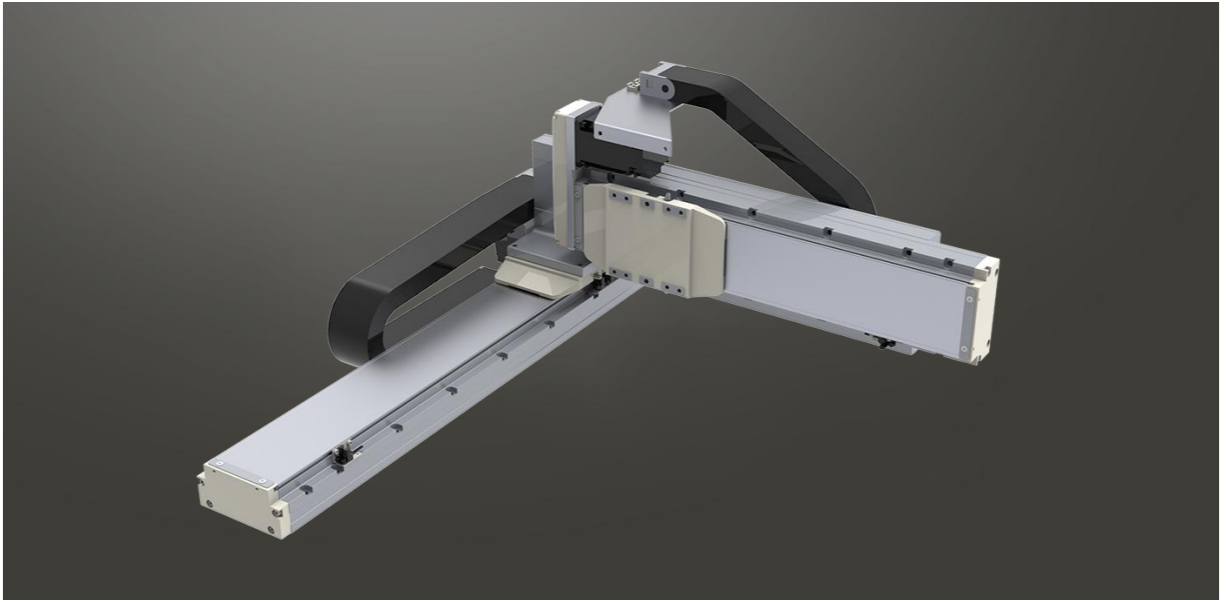

此圖僅供參考，出貨規格詳見尺寸圖面
The picture is just for the reference. Please check the the actual dimensions on the drawing.

※標準連結滑台不提供同動精度
Assembly accuracy is not guaranteed for the standard multi-axis system.

最大行程 Maximum Stroke

X軸
X axis 1250mm

Y軸
Y axis 導程20:500 mm/s

Y軸
Y axis 導程10:600 mm/s

最高速度 Maximum Speed

X軸
X axis 導程20:1000 mm/s

Y軸
Y axis 導程20:1000 mm/s

X軸
X axis 導程10:500 mm/s

Y軸
Y axis 導程10:500 mm/s

AC伺服馬達容量 AC Servo Motor Output

X軸
X axis 400W

Y軸
Y axis 400W

基本仕様 Specification

項目 Item	導程組合A Lead Composition A		導程組合C Lead Composition C	
	X軸 X axis	Y軸 Y axis	X軸 X axis	Y軸 Y axis
軸型式 Model Type	HPG12	HPG12	HPG12	HPG12
位置重複精度 Repeatability (mm)	±0.01	±0.01	±0.01	±0.01
螺桿導程 Ball screw lead (mm)	20	20	10	10
最高速度 Maximum Speed (mm/s)※1	1000	1000	500	500
標準行程(50間隔) Stroke 50 mm Pitch (mm)	50~1250	100~500	50~1250	100~600
AC伺服馬達容量 AC Servo Motor Output (w)	400	400	400	400
使用環境 Environment	0~40°C, 85%RH Below			

※1: 最高速度(mm/s)是以伺服馬達最高轉速3000rpm/min為基準。Maximum speed is based on the AC servo motor's 3000RPM.

最大可搬重量 Maximum Payload

導程組合A Lead Composition X軸 X axis:L20 Y軸 Y axis:L20	Y軸行程 Y Stroke Y軸荷重 Y Payload	Y Stroke								
		100	150	200	250	300	350	400	450	500
		100	150	200	250	300	350	400	450	500
		26	26	24	19	15	11	7	4	2

導程組合C Lead Composition X軸 X axis:L10 Y軸 Y axis:L10	Y軸行程 Y Stroke Y軸荷重 Y Payload	Y Stroke										
		100	150	200	250	300	350	400	450	500	550	600
		100	150	200	250	300	350	400	450	500	550	600
		57	56	39	31	26	20	16	12	9	5	3

※限定水平安裝。Only for horizontal installation.

型號表示方式 Ordering Method

XYG440 - A 1 - C - 500 - 300 - T - C - 0001

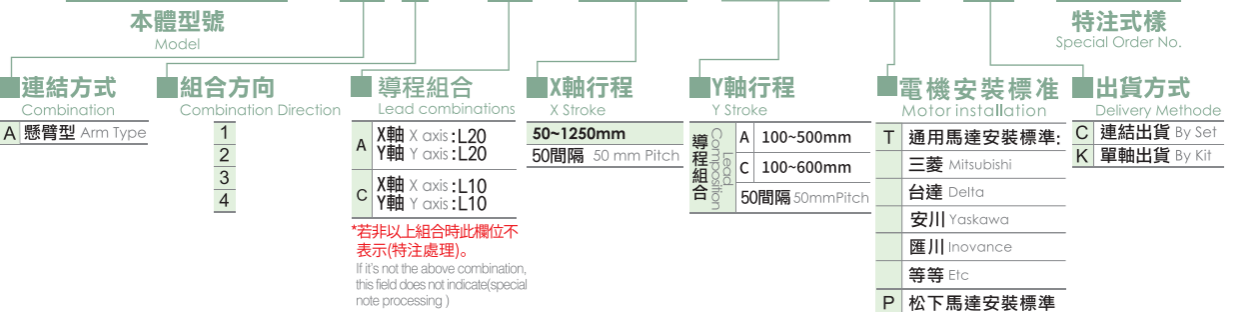

XYG440-A1 尺寸圖 Size

單位 Unit: mm

A1

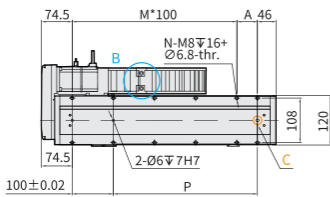
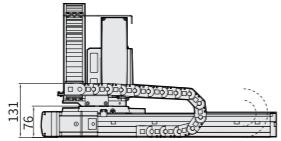
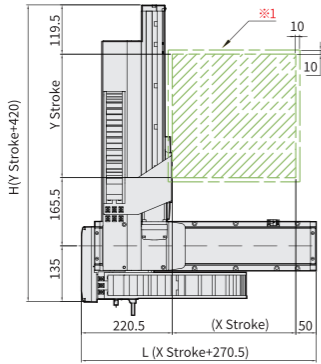

XY-Cable Chain

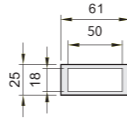

A-Detail View

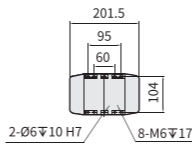

D-Detail View

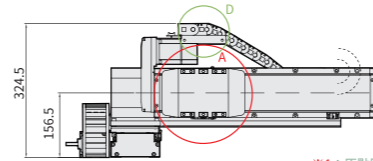
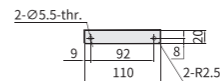

B-Detail View

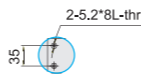

C View

※1: 原點回復時的移動範圍及機械極限的停止位置。
(When the moving range return to origin, the stop position of table's movement range and mechanical limit.)

※2: 最高速度(mm/s)是以伺服馬達最高轉速3000rpm/min為基準。
(Maximum speed is based on the AC servo motor's 3000 RPM)

※3: 最高使用速度代表該行程內可使用的最高安全速度，若超過此速度，滑台可能有嚴重共振產生。
(Maximum speed refers to the highest safe speed that can be used in stroke, if more than the standard speed, table may produce serious resonance.)

X軸有效行程 X Stroke (mm)	50	100	150	200	250	300	350	400	450	500	550	600	650	700	750	800	850	900	950	1000	1050	1100	1150	1200	1250										
L	320.5	370.5	420.5	470.5	520.5	570.5	620.5	670.5	720.5	770.5	820.5	870.5	920.5	970.5	1020.5	1070.5	1120.5	1170.5	1220.5	1270.5	1320.5	1370.5	1420.5	1470.5	1520.5										
A	100	50	100	50	100	50	100	50	100	50	100	50	100	50	100	50	100	50	100	50	100	50	100	50	100										
M	1	2	2	3	3	4	4	5	5	6	6	7	7	8	8	9	9	10	10	11	11	12	12	13	13										
N	6	8	8	10	10	12	12	14	14	16	16	18	18	20	20	22	22	24	24	26	26	28	28	30	30										
P	100	150	200	250	300	350	400	450	500	550	600	650	700	750	800	850	900	1000	1050	1100	1150	1200	1250	1300	1350										
導程組合A 最高使用速度 Lead Composition A Maximum speed (mm/s)																		1000 ^{※2※3}			900					800	700	667	633	600	533	500	467		
導程組合C 最高使用速度 Lead Composition C Maximum speed (mm/s)																		500 ^{※2※3}					450					400	350	333	317	300	267	250	233

Y軸有效行程 Y Stroke (mm)	100	150	200	250	300	350	400	450	500	550	600
H	520	570	620	670	720	770	820	870	920	970	1020
導程組合A 最高使用速度 Lead Composition A Maximum speed (mm/s)	1000										
導程組合C 最高使用速度 Lead Composition C Maximum speed (mm/s)	500										

連結方向 Combination Direction

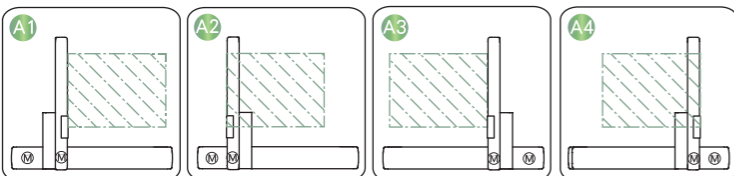

配件規格 Spec. Details

X軸詳細規格 X-axis Detail Spec.	→P055	Y軸詳細規格 Y-axis Detail Spec.	→P055
Z軸詳細規格 Z-axis Detail Spec.	-	馬達廠牌選定 Motor Brand Options	→P427